

Soils Map

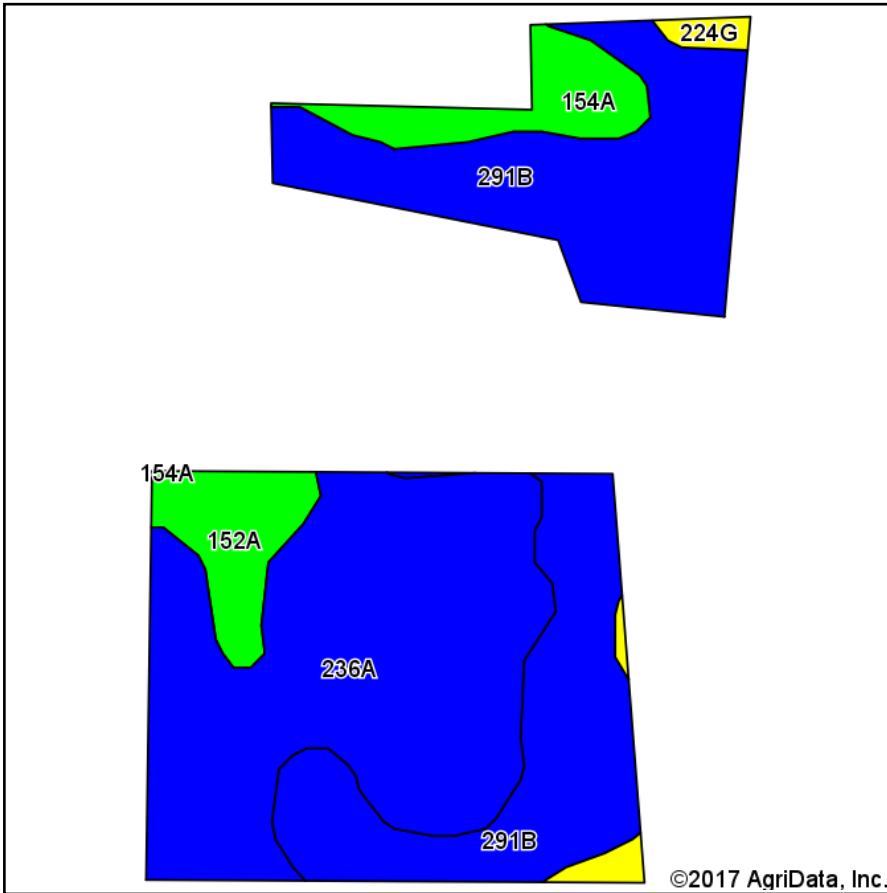

Soils data provided by USDA and NRCS.

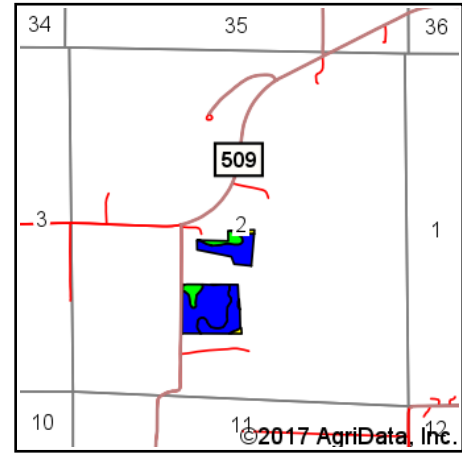

State: **Illinois**
 County: **Vermilion**
 Location: **2-17N-12W**
 Township: **Georgetown**
 Acres: **22.5**
 Date: **8/29/2017**



Maps Provided By:



© AgriData, Inc. 2017

www.AgriDataInc.com



Area Symbol: IL183, Soil Area Version: 12

Code	Soil Description	Acres	Percent of field	Il. State Productivity Index Legend	Corn Bu/A	Soybeans Bu/A	Crop productivity index for optimum management
**291B	Xenia silt loam, Bloomington Ridged Plain, 2 to 5 percent slopes	9.66	42.9%		**160	**50	**117
236A	Sabina silt loam, 0 to 2 percent slopes	9.55	42.4%		168	52	122
152A	Drummer silty clay loam, 0 to 2 percent slopes	1.42	6.3%		195	63	144
154A	Flanagan silt loam, 0 to 2 percent slopes	1.41	6.3%		194	63	144
**224G	Strawn silt loam, 35 to 75 percent slopes	0.46	2.0%		**67	**23	**50
Weighted Average					165.8	51.9	121.1

Table: Optimum Crop Productivity Ratings for Illinois Soil by K.R. Olson and J.M. Lang, Office of Research, ACES, University of Illinois at Champaign-Urbana. Version: 1/2/2012 Amended Table S2 B811

Crop yields and productivity indices for optimum management (B811) are maintained at the following NRES web site:

<https://www.ideals.illinois.edu/handle/2142/1027/>

** Indexes adjusted for slope and erosion according to Bulletin 811 Table S3

Soils data provided by USDA and NRCS. Soils data provided by University of Illinois at Champaign-Urbana.

*c: Using Capabilities Class Dominant Condition Aggregation Method